

# LUNA ATOM™ 2 PENDANT

PROJECT: \_\_\_\_\_

TYPE: \_\_\_\_\_

QUANTITY: \_\_\_\_\_



PN:971LUAT2

INDOOR

<b>APPLICATION</b>	<ul style="list-style-type: none"> <li>• DIRECT OR DIRECT/INDIRECT PENDANT</li> <li>• INDOOR RATED</li> </ul>
<b>DIMENSION</b>	<ul style="list-style-type: none"> <li>• COMBINATION OF 2 RINGS FROM DIAMETERS OF 24", 36", 48", 60", 72" AND 84" (61CM, 91CM, 122CM, 152CM, 182CM, 213CM)</li> <li>• PROFILE: 1"W X 2.38"H (2.5CM X 6CM)</li> </ul>
<b>ILLUMINATION</b>	<ul style="list-style-type: none"> <li>• DIRECT OR INDIRECT/DIRECT</li> <li>• LED 90CRI</li> <li>• 7,709 - 39,519 LUMENS</li> </ul>
<b>ELECTRICAL</b>	<ul style="list-style-type: none"> <li>• 120 - 277V</li> <li>• 10KV SURGE SUPPRESSION STANDARD</li> </ul>
<b>DIFFUSERS</b>	<ul style="list-style-type: none"> <li>• HIGH EFFICIENCY ACRYLIC</li> </ul>
<b>MOUNTING</b>	<ul style="list-style-type: none"> <li>• 96" (244CM) CORD &amp; AIRCRAFT CABLE SUPPLIED</li> <li>• SPECIFY BLACK OR WHITE CORD</li> </ul>
<b>CONSTRUCTION</b>	<ul style="list-style-type: none"> <li>• ALUMINUM</li> </ul>
<b>FINISHES</b>	<ul style="list-style-type: none"> <li>• AVAILABLE IN SEVERAL TMS POWDER COATED FINISHES</li> <li>• CUSTOM RAL FINISHES AVAILABLE</li> </ul>
<b>DIMMING</b>	<ul style="list-style-type: none"> <li>• 0 - 10V STANDARD DIMMING</li> </ul>
<b>WEIGHT</b>	<ul style="list-style-type: none"> <li>• 27 - 75 LBS</li> </ul>

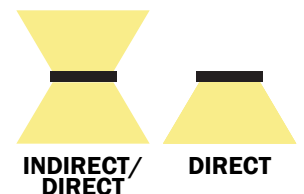



# LUNA ATOM™ 2 PENDANT

PROJECT: \_\_\_\_\_

TYPE: \_\_\_\_\_

QUANTITY: \_\_\_\_\_

## 971LUAT2

1      2      3      4      5      6      7      8

1.	DIRECT									
CLUSTER	SD			MD			LD			CUS
DIA	24", 36"			48", 60"			72", 84"			CUSTOM (SPECIFY)
LED (W)	85			153			220			
LUMENS	7709			13924			20013			
	INDIRECT/DIRECT									
CLUSTER	SID			MID			LID			CUS
DIA	24", 36"			48", 60"			72", 84"			CUSTOM (SPECIFY)
LED (W)	170			304			440			
LUMENS	15195			27500			39519			
2.	H			M			L			C: _____ <sup>1</sup>
OUTPUT	100% LUMENS			75% LUMENS			50% LUMENS			[CUSTOM]% LUMENS
3.	30K			35K			40K			
CCT	3000K			3500K			4000K			
4.	UNI									
VOLTAGE	120 - 277V									
5.	S					D				
CIRCUITS	SINGLE					DUAL				
6.	BC					WC				
CORD	BLACK DROP CORD					WHITE DROP CORD				
7.	F04	F05	F09	F15	F16	F18	F21	F31	F33	RAL
FINISH	MATTE WHITE	GLOSS WHITE	PEWTER	MATTE BLACK	GLOSS BLACK	SATIN ALUMINUM	ARCH BRONZE	SILVER METALLIC	PYRITE BRONZE	CUSTOM (SPECIFY)
8.	DIML									
DIMMING	STANDARD 0 - 10V									

1. CUSTOM PERCENTAGE I.E. 60%. CONSULT AGENT

NOTE: SOME OPTIONS MAY NOT BE COMPATIBLE WITH OTHERS. ALL SPECIFICATIONS ARE SUBJECT TO CHANGE WITHOUT NOTICE. CONTACT TMS LIGHTING FOR UPDATED SPECIFICATIONS.

# LUNA ATOM™ 2 PENDANT

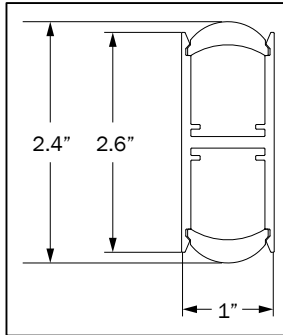
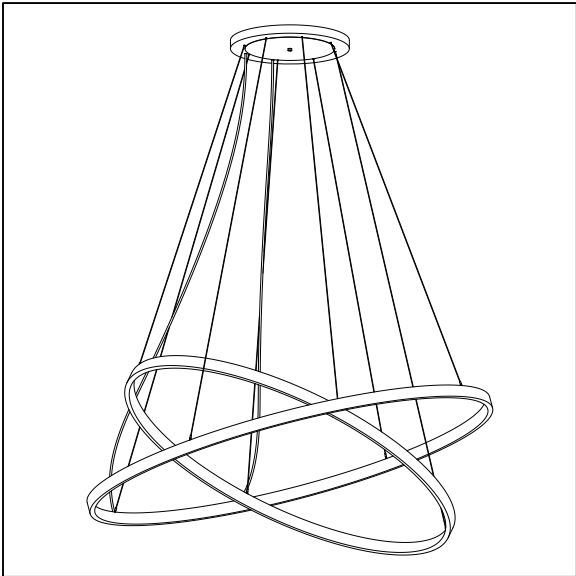
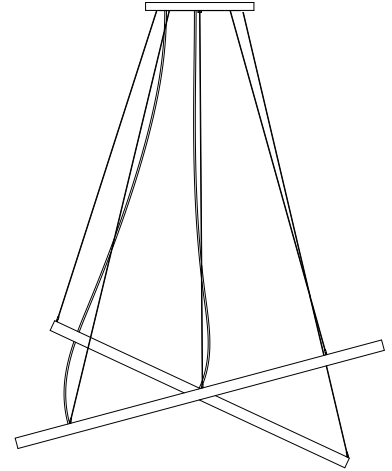
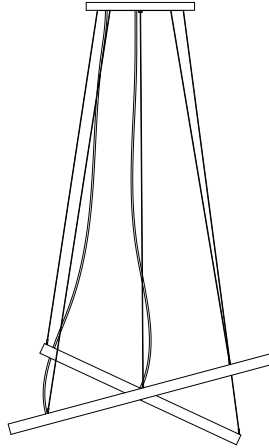
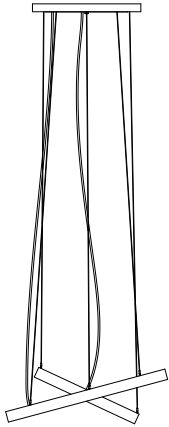

SIZE (DIA)	MINIMUM CORD LENGTH	WEIGHT (LBS)
24"	15"	13
36"	20"	18
48"	35"	24
60"	55"	30
72"	70"	36
84"	85"	45

# LUNA ATOM™ 2 PENDANT

## DIRECT

PN	SIZE (DIA)	LUMENS	WATTAGE
971LU	24D	3101	34
	36D	4608	51
	48D	6158	68
	60D	7766	85
	72D	9270	102
	84D	10743	118

### IES INDOOR REPORT

PHOTOMETRIC FILENAME : 971LU 84 D 35K F05.IES

### POLAR GRAPH

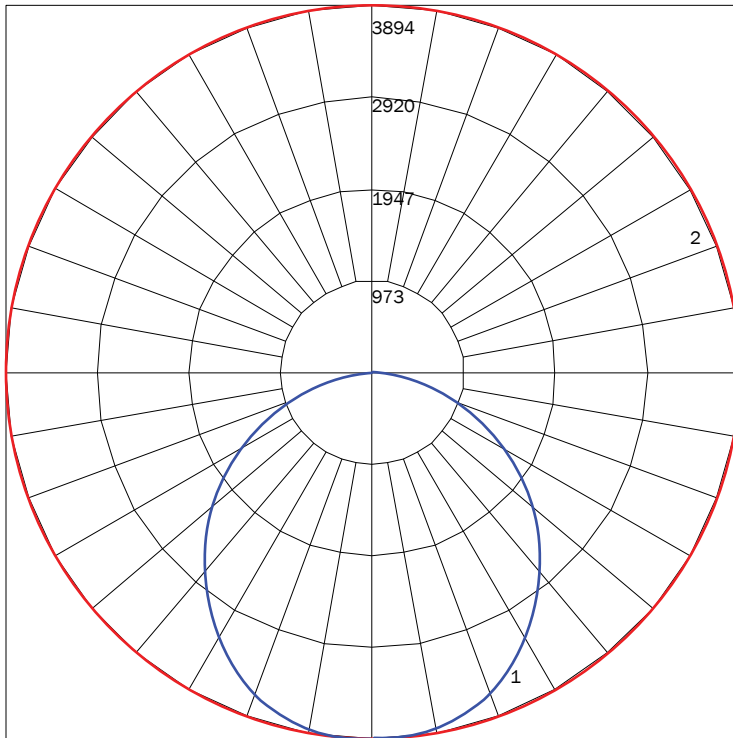

MAXIMUM CANDELA = 3893.9 LOCATED AT HORIZONTAL ANGLE = 90, VERTICAL ANGLE = 5  
 # 1 - VERTICAL PLANE THROUGH HORIZONTAL ANGLES (90 - 270) (THROUGH MAX. CD.)  
 # 2 - HORIZONTAL CONE THROUGH VERTICAL ANGLE (5) (THROUGH MAX. CD.)

<b>LUMINAIRE LUMENS</b>	10743
<b>TOTAL LUMINAIRE EFFICIENCY</b>	71%
<b>LUMINAIRE EFFICACY RATING</b>	91
<b>TOTAL LUMINAIRE WATTS</b>	118

## INDIRECT / DIRECT

PN	SIZE (DIA)	LUMENS	WATTAGE
971LU	24ID	6104	68
	36ID	9091	102
	48ID	12185	135
	60ID	15315	169
	72ID	18173	203
	84ID	21346	237

### IES INDOOR REPORT

PHOTOMETRIC FILENAME : 971LU 84 ID 35K F05.IES

### POLAR GRAPH

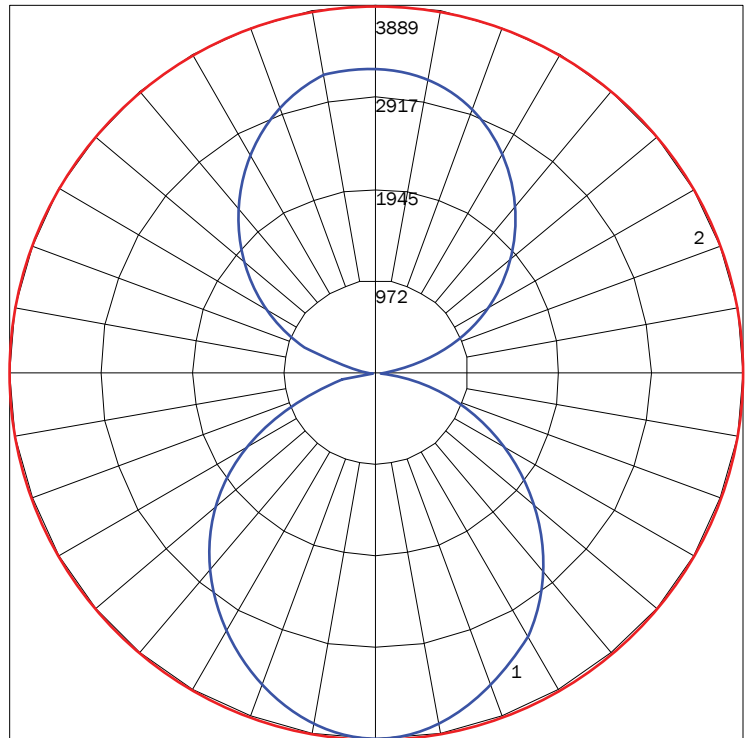

MAXIMUM CANDELA = 3889.18 LOCATED AT HORIZONTAL ANGLE = 67.5, VERTICAL ANGLE = 5  
 # 1 - VERTICAL PLANE THROUGH HORIZONTAL ANGLES (67.5 - 247.5) (THROUGH MAX. CD.)  
 # 2 - HORIZONTAL CONE THROUGH VERTICAL ANGLE (5) (THROUGH MAX. CD.)

<b>LUMINAIRE LUMENS</b>	21346
<b>TOTAL LUMINAIRE EFFICIENCY</b>	71%
<b>LUMINAIRE EFFICACY RATING</b>	90
<b>TOTAL LUMINAIRE WATTS</b>	237

NOTE: IES reflects one single Luna ring fixture each. Combine multiple for desired combination output.

# LUNA ATOM™ 2 PENDANT

## AVAILABLE FINISHES



**F04**  
MATTE  
WHITE



**F05**  
GLOSS  
WHITE



**F09**  
PEWTER



**F15**  
MATTE  
BLACK



**F16**  
GLOSS  
BLACK



**F18**  
SATIN  
ALUMINUM



**F21**  
ARCH  
BRONZE



**F31**  
SILVER  
METALLIC



**F33**  
PYRITE  
BRONZE



**RAL**  
CUSTOM  
COLOR  
(RAL #)

NOTE: DISPLAYED FINISHES DIFFER BETWEEN SCREENS AS WELL AS PRINTERS AND MAY NOT ACCURATELY DEPICT COLOR.