

PROJECT: _____

TYPE: _____

QUANTITY: _____



PN: JOO

APPLICATION	<ul style="list-style-type: none"> • PENDANT MOUNT • INDOOR RATED
DIMENSION	<ul style="list-style-type: none"> • 14", 18", 24", 36", 40" (35CM, 45CM, 61CM, 91CM, 102CM)
ILLUMINATION	<ul style="list-style-type: none"> • DIRECT • LED 90CRI • 1,858 - 2,740 LUMENS
ELECTRICAL	<ul style="list-style-type: none"> • 120 - 277V (347V CONSULT FACTORY) • 10kA SURGE SUPPRESSION STANDARD
DIFFUSERS	<ul style="list-style-type: none"> • HIGH EFFICIENCY ACRYLIC
MOUNTING	<ul style="list-style-type: none"> • 96" (244CM) BLACK OR WHITE DROP CORD W/ AIRCRAFT CABLE
CONSTRUCTION	<ul style="list-style-type: none"> • ALUMINUM
FINISHES	<ul style="list-style-type: none"> • AVAILABLE IN SEVERAL TMS PLATED, AND POWDER COATED FINISHES • CUSTOM RAL FINISHES AVAILABLE
DIMMING	<ul style="list-style-type: none"> • 0 - 10V STANDARD DIMMING
WEIGHT	<ul style="list-style-type: none"> • WITHOUT LOUVER: 4 LBS TO 29 LBS MAXIMUM



JOOPI™ PENDANT



PROJECT: _____

TYPE: _____

QUANTITY: _____

JOO

1 2 3 4 5 6 7 8 9 10 11 12

1.	14		18		24		36		40	
DIAMETER	14"DIA (35CM)		18"DIA (45CM)		24"DIA (61CM)		36"DIA (91CM)		40"DIA (102CM)	
2.										
ILLUMINATION	100IN	19LED	100IN	19LED	100IN	19LED	100IN	32LED	100IN	32LED
LED (W)	100W	19W	100W	19W	100W	19W	100W	32W	100W	32W
LUMENS	---	1858	---	1885	---	1825	---	2735	---	2740

3.	CRD									
MOUNTING	120" DROP CORD (305CM)									

4.	30K			35K			40K		
LED CCT	3000			3500			4000		

5.	120					277				
VOLTAGE	120V					277V				

6.	BC					WC				
CORD	BLACK DROP CORD					WHITE DROP CORD				

7.	ADDITIONAL AND PREMIUM FINISHES AVAILABLE. SEE FINISHES CHART	F04	F05	F15	F16	F09	F31	F18
FINISH		MATTE WHITE	GLOSS WHITE	MATTE BLACK	GLOSS BLACK	PEWTER	SILVER METALLIC	SATIN ALUMINUM

8.	00	F05	F10	F14	F15	F18
ACCENT FINISH	SAME AS OUTSIDE	GLOSS WHITE	FIRE RED	SUNSHINE YELLOW	MATTE BLACK	SATIN ALUMINUM

9.	---				DIML			
DIMMING	NONE				0 - 10V DIMMING (1%)			

10.	---				EMR			
EMERGENCY ¹	NONE				REMOTE			

11.	ACC									
MOUNTING ² ACCESSORIES	AIRCRAFT CABLE FOR DROP CORDS									

12.	---	LV05	LV15	LV22	LV31	LVRS	LV05	LV15	LV22	LV31
LOUVER	NONE	24"F05 WHITE	24" F15 MATTE BLACK	24" HARVEST GOLD	24" F31 SILVER METALLIC	24" ROSE GOLD	36" F05 WHITE	36" MATTE BLACK	36" HARVEST GOLD	36" F31 SILVER METALLIC
	LVRS	LV05	LV15	LV22	LV31	LVRS				
	36" ROSE GOLD	40"F05 WHITE	40" F15 MATTE BLACK	40" HARVEST GOLD	40" F31 SILVER METALLIC	40" ROSE GOLD				

1. 10W AT 90 MINUTES
2. MAY REQUIRE TO COMPLY WITH THE LOCAL SEISMIC/EARTHQUAKE CODE

NOTE: SOME OPTIONS MAY NOT BE COMPATIBLE WITH OTHERS. ALL SPECIFICATIONS ARE SUBJECT TO CHANGE WITHOUT NOTICE. CONTACT TMS LIGHTING FOR UPDATED SPECIFICATIONS.

JOO - 14"

4LB

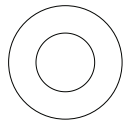
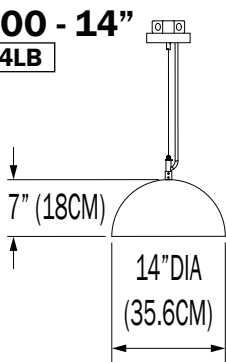

JOO - 18"

8LB

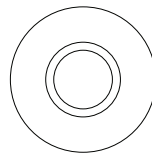
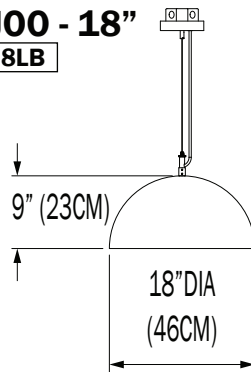

JOO - 24"

12LB

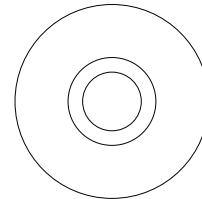
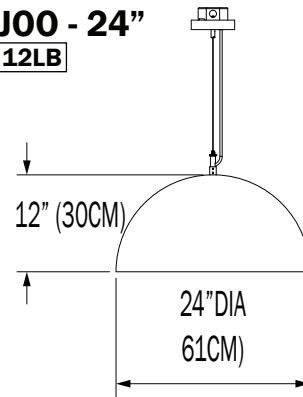

JOO - 36"

23LB

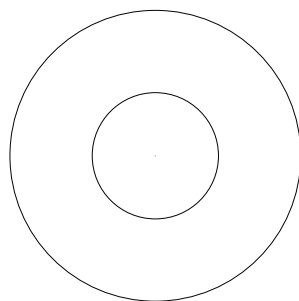
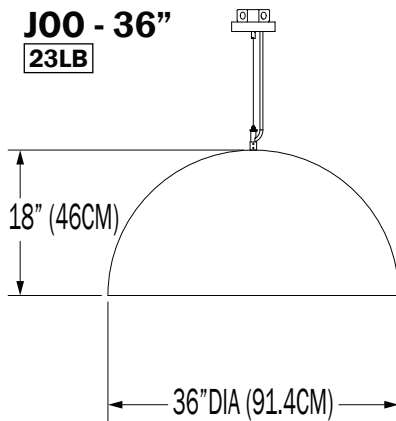

JOO - 40"

29LB

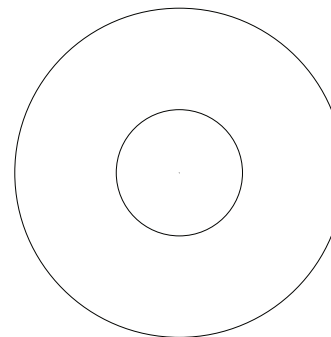
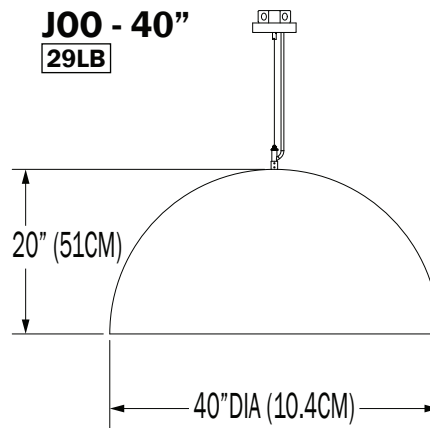

CUSTOM

NOTE: THIS FIXTURE CAN BE CUSTOMIZE. DIMENSION, LAMP TYPES, ENCLOSURE, AND COLOR CAN BE MODIFIED TO SUIT YOUR LIGHTING AND ARCHITECTURAL REQUIREMENTS. CONTACT YOUR LOCAL REPRESENTATIVE FOR MORE DETAILS: <https://tmslighting.com/sales-agents.html>

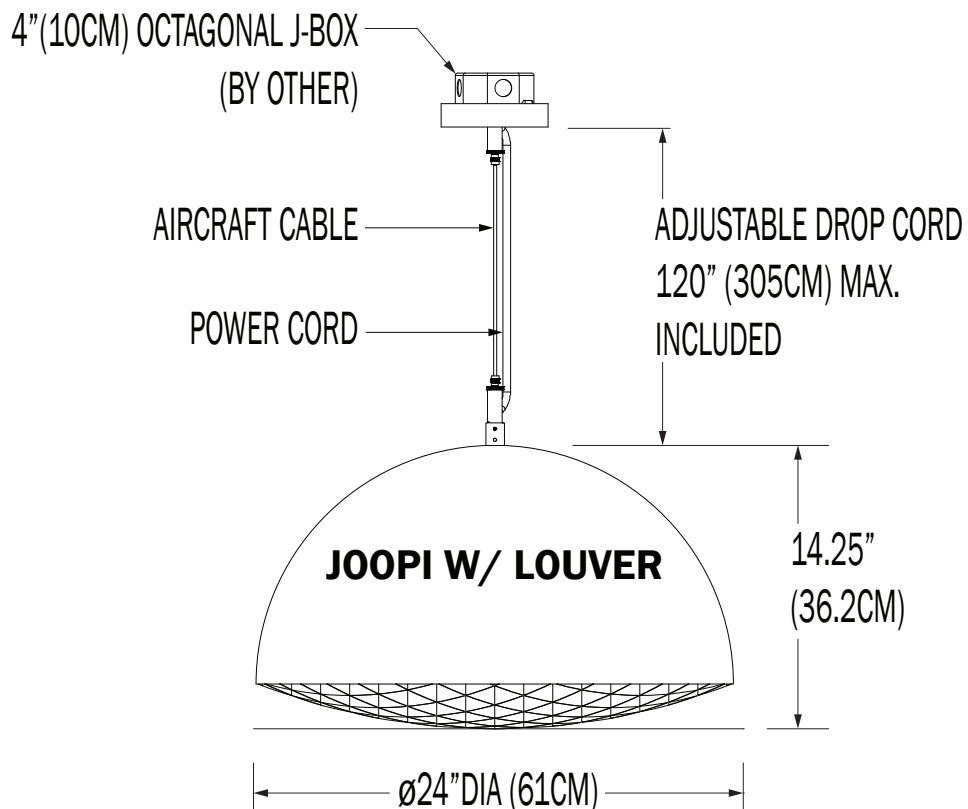
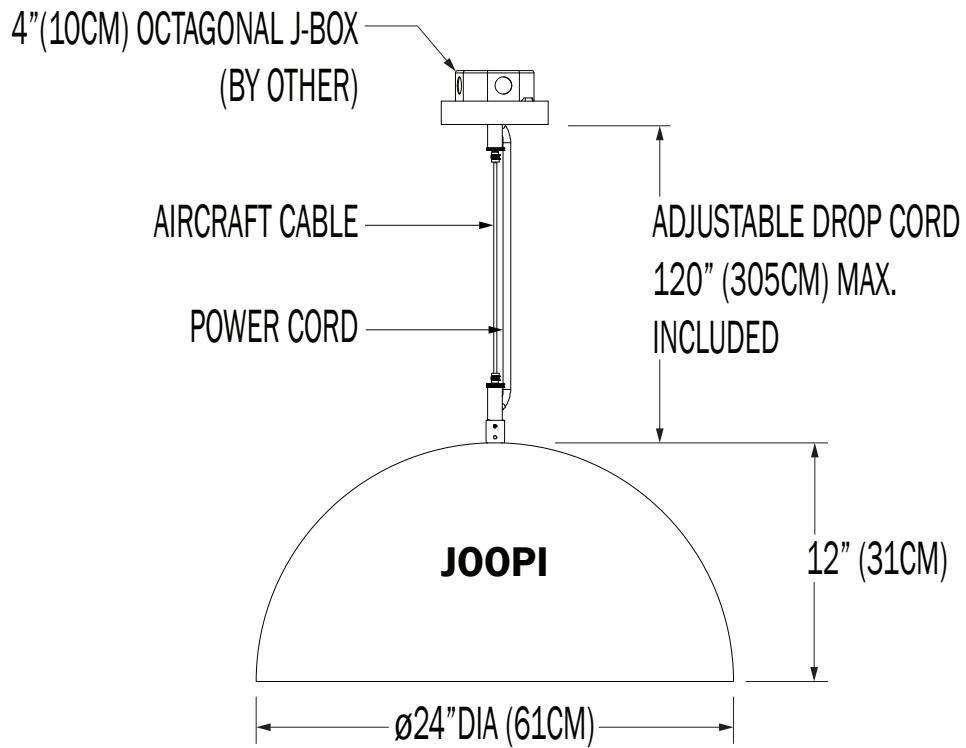

DIRECT

PN	SIZE (DIA)	ILLUMINATION	LUMENS	WATTAGE
J00	14	19LED	1858	19
	18	19LED	1885	19
	24	19LED	1825	19
	36	32LED	2735	32
	40	32LED	2740	32

IES INDOOR REPORT

PHOTOMETRIC FILENAME : J00 18 19LED 35K F05.IES

POLAR GRAPH

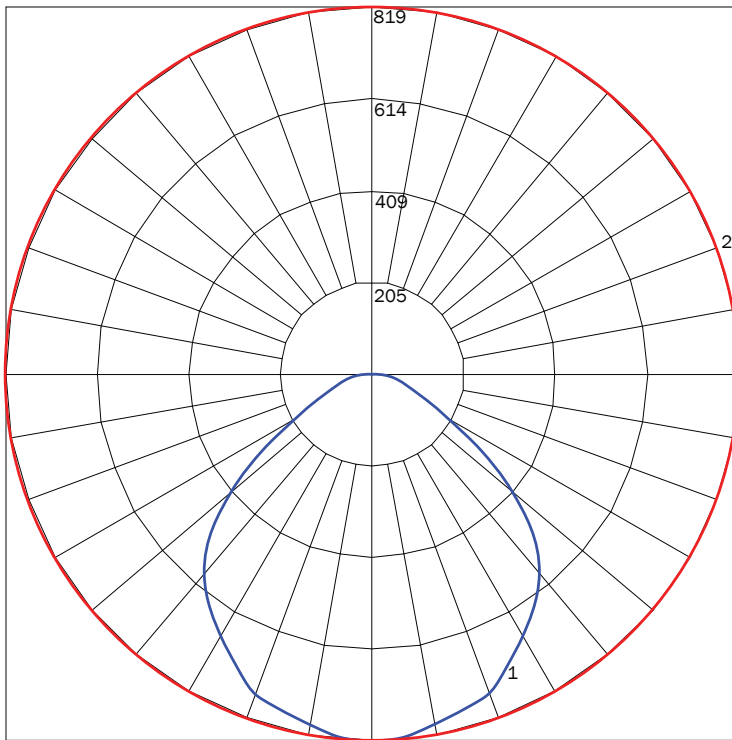

MAXIMUM CANDELA = 818.65 LOCATED AT HORIZONTAL ANGLE = 0, VERTICAL ANGLE = 0
 # 1 - VERTICAL PLANE THROUGH HORIZONTAL ANGLES (0 - 180) (THROUGH MAX. CD.)
 # 2 - HORIZONTAL CONE THROUGH VERTICAL ANGLE (0) (THROUGH MAX. CD.)

LUMINAIRE LUMENS

1885

TOTAL LUMINAIRE EFFICIENCY

72%

LUMINAIRE EFFICACY RATING

95

TOTAL LUMINAIRE WATTS

20

IES INDOOR REPORT

PHOTOMETRIC FILENAME : J00 40 32LED 35K F05.IES

POLAR GRAPH

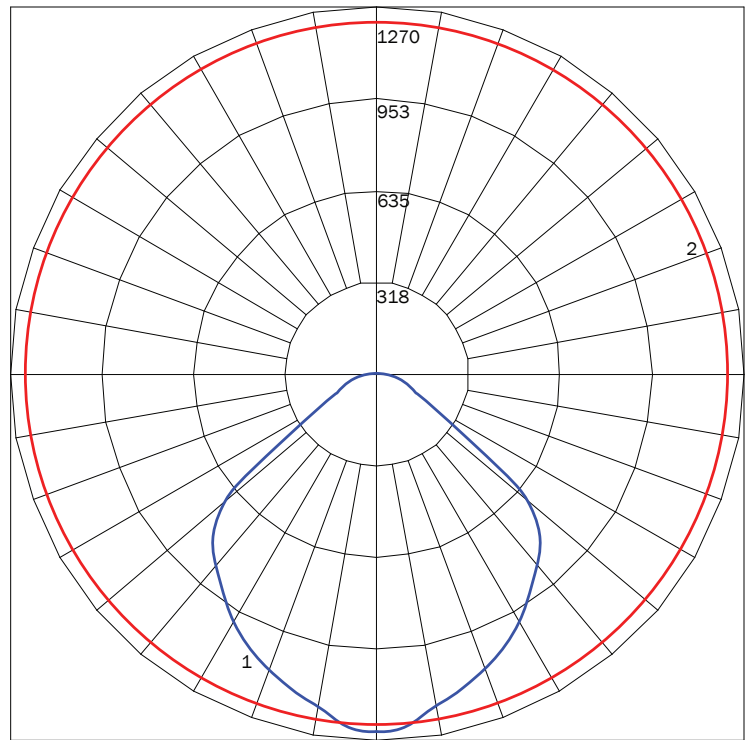

MAXIMUM CANDELA = 1270.09 LOCATED AT HORIZONTAL ANGLE = 180, VERTICAL ANGLE = 5
 # 1 - VERTICAL PLANE THROUGH HORIZONTAL ANGLES (180 - 0) (THROUGH MAX. CD.)
 # 2 - HORIZONTAL CONE THROUGH VERTICAL ANGLE (5) (THROUGH MAX. CD.)

LUMINAIRE LUMENS

2740

TOTAL LUMINAIRE EFFICIENCY

71%

LUMINAIRE EFFICACY RATING

86

TOTAL LUMINAIRE WATTS

32

FINISHES

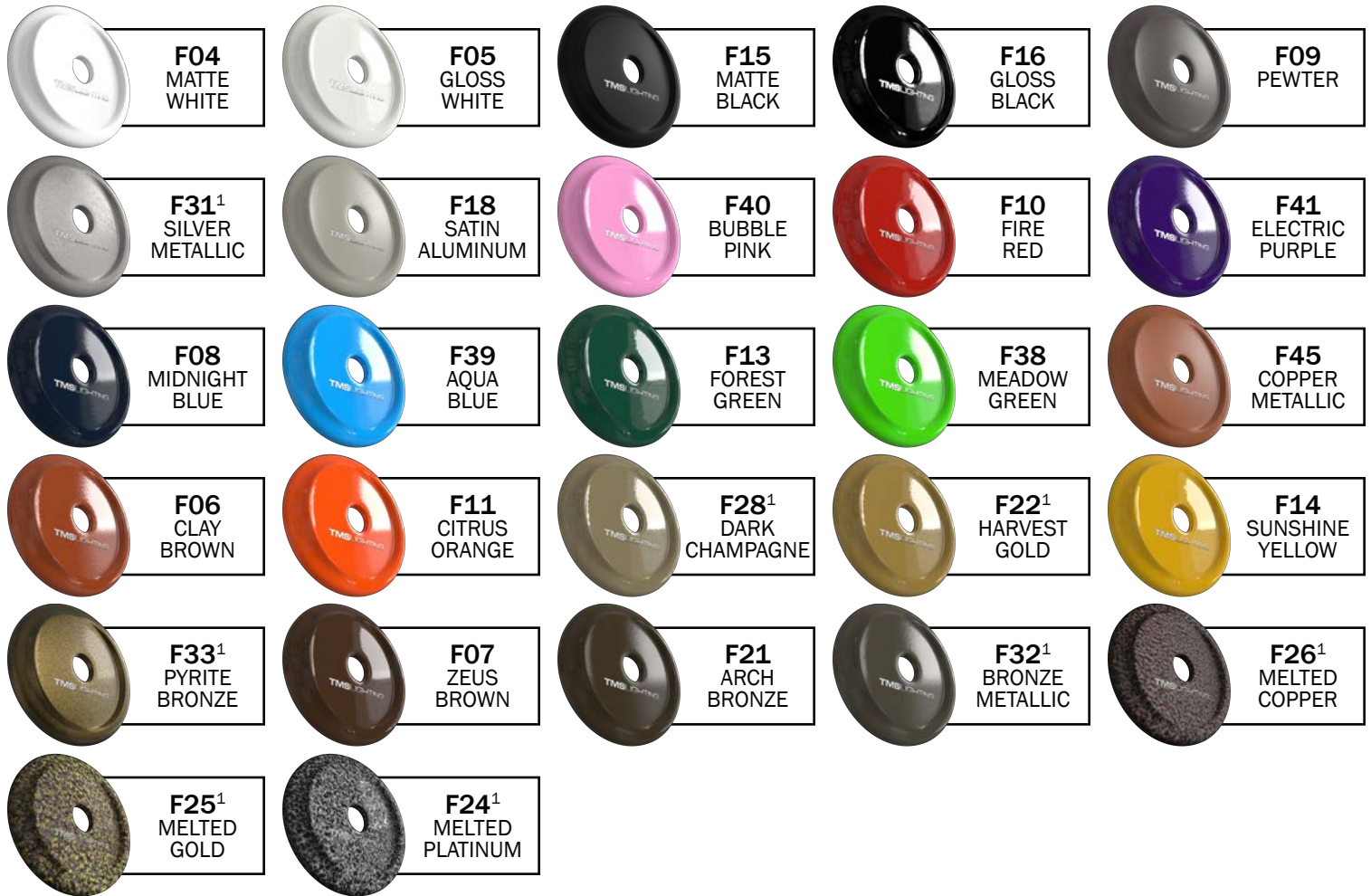

PREMIUM FINISHES



1: FINISHES IS APPLIED TO THE INTERIOR AND EXTERIOR OF THE FIXTURE.

2: MATERIALS ARE CONSISTENT (INTERIOR & EXTERIOR). STEMS AND CANOPIES WILL BE F16 GLOSS BLACK.

NOTE: ALL FINISHES NOT MARKED WITH NOTATION (1) ARE APPLIED TO THE EXTERIOR ONLY. THE INTERIOR WILL BE F05 GLOSS WHITE.

MATTE FINISHES AVAILABLE. CONSULT FACTORY.

FINISHES ARE SUBJECT TO AVAILABILITY AND MAY NOT BE APPLICABLE TO ALL FIXTURES OR FOR QUICKSHIP.

DISPLAYED FINISHES DIFFER BETWEEN SCREENS AS WELL AS PRINTERS AND MAY NOT ACCURATELY DEPICT COLOR.