

# FLUX DIRECT™ PENDANT

PROJECT: \_\_\_\_\_

TYPE: \_\_\_\_\_

QUANTITY: \_\_\_\_\_

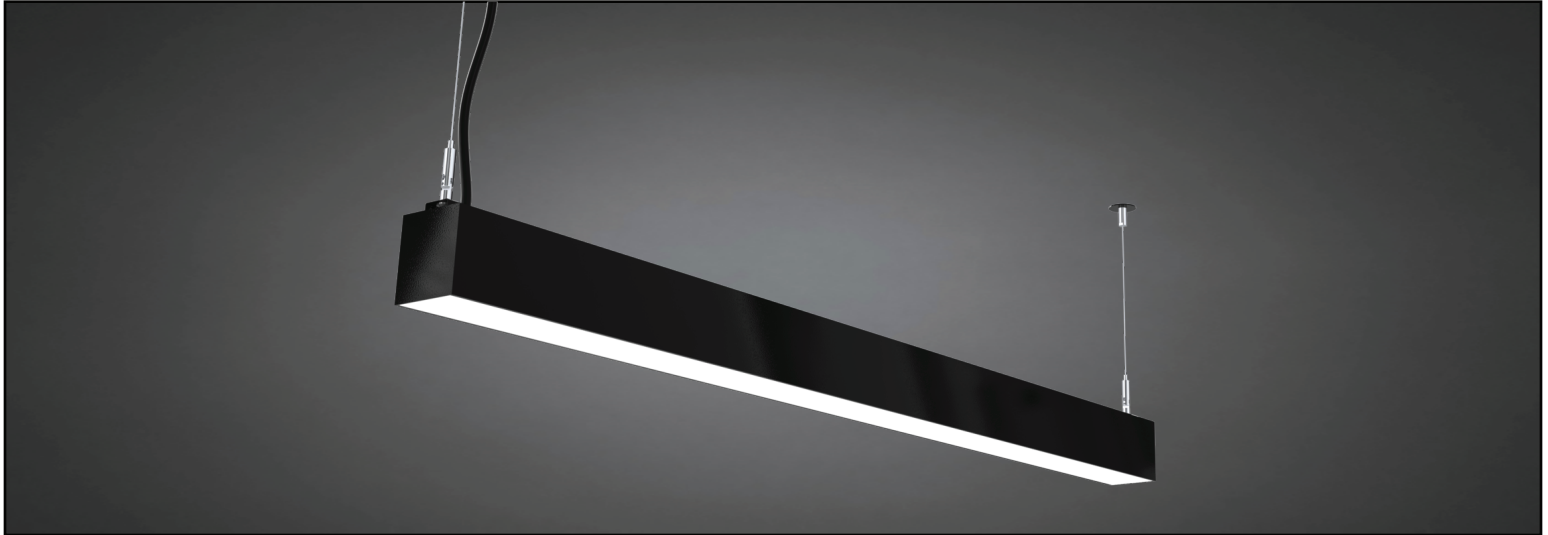

PN: 470FL

<b>APPLICATION</b>	<ul style="list-style-type: none"><li>• PENDANT MOUNT</li><li>• INDOOR RATED</li></ul>
<b>DIMENSION</b>	<ul style="list-style-type: none"><li>• 24", 48", 72", 96", 120", 144" (61CM, 122CM, 183CM, 244CM, 305CM, 366CM)</li><li>• PROFILE: 2.756"W X 3.450"H (7CM X 8.8CM)</li></ul>
<b>ILLUMINATION</b>	<ul style="list-style-type: none"><li>• DIRECT</li><li>• LED 90CRI</li><li>• 2,799 - 17,112 LUMENS</li></ul>
<b>ELECTRICAL</b>	<ul style="list-style-type: none"><li>• 120, 277V AND UNI (120 - 277V)</li><li>• 10kA SURGE SUPPRESSION STANDARD</li></ul>
<b>DIFFUSERS</b>	<ul style="list-style-type: none"><li>• HIGH EFFICIENCY ACRYLIC</li></ul>
<b>MOUNTING</b>	<ul style="list-style-type: none"><li>• 96" (244CM) BLACK OR WHITE DROP CORD W/ AIRCRAFT CABLES</li></ul>
<b>CONSTRUCTION</b>	<ul style="list-style-type: none"><li>• ALUMINUM</li></ul>
<b>FINISHES</b>	<ul style="list-style-type: none"><li>• AVAILABLE SPECIALTY, AND IN SEVERAL TMS POWDER COATED FINISHES</li><li>• CUSTOM RAL FINISHES AVAILABLE</li></ul>
<b>DIMMING</b>	<ul style="list-style-type: none"><li>• 0 - 10V STANDARD DIMMING (1%)</li></ul>



TMSLIGHTING



# FLUX DIRECT™ PENDANT

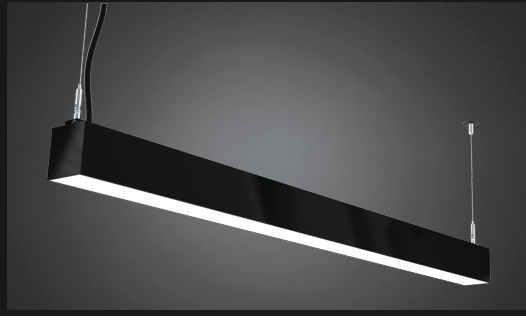

PROJECT: \_\_\_\_\_

TYPE: \_\_\_\_\_

QUANTITY: \_\_\_\_\_

**470FL**

1 2 3 4 5 6 7 8 9 10 11

<b>1.</b>	<b>24D</b>	<b>48D</b>	<b>72D</b>	<b>96D</b>	<b>120D</b>	<b>144D</b>
LENGTH	24"(61CM) DIRECT	48"(122CM) DIRECT	72"(183CM) DIRECT	96"(244CM) DIRECT	120"(305CM) DIRECT	144"(366CM) DIRECT
LED (W)	27W	52W	78W	104W	130W	156W
LENGTH	2799	5767	8653	11630	14258	17112

<b>2.</b>	<b>30K</b>	<b>35K</b>	<b>40K</b>
LED CCT	3000K	3500K	4000K

<b>3.</b>	<b>120</b>	<b>277</b>	<b>UNI</b>
VOLTAGE	120V	277V	120 - 227V

<b>4.</b>	<b>S</b>
CIRCUITS	SINGLE

<b>5.</b>	<b>SW</b>	<b>BL</b>
DIFFUSER	SATIN	BLACK LENS

<b>6.</b>	<b>ACC</b>	<b>ACT</b>
MOUNTING	CABLE & CORD	CABLE & CORD FOR T-BAR

<b>7.</b>	<b>BC</b>	<b>WC</b>
CORD	BLACK DROP CORD	WHITE DROP CORD

<b>8.</b>	<b>AN</b>	<b>F04</b>	<b>F05</b>	<b>F15</b>	<b>F16</b>	<b>F18</b>	<b>RAL</b>
FINISH	ANODIZED (SILVER)	MATTE WHITE	GLOSS WHITE	MATTE BLACK	GLOSS BLACK	SATIN PLATINUM	CUSTOM (SPECIFY)

<b>9.</b>	<b>---</b>	<b>EMR</b>
EMERGENCY <sup>1</sup>	NONE	REMOTE

<b>10.</b>	<b>---</b>	<b>DOS</b>	<b>DS</b>	<b>OS</b>
SENSORS	NONE	DAYLIGHT/OCCUPANCY	DAYLIGHT	OCCUPANCY

<b>11.</b>	<b>DIML</b>
DIMMING	LED DIMMING (0 - 10V, CURRENT - SINKING)

1. 10W AT 90 MINUTES. EMERGENCY (EMR) OPTION ILLUMINATES MAX OF 4 FT.

NOTE: SOME OPTIONS MAY NOT BE COMPATIBLE WITH OTHERS. ALL SPECIFICATIONS ARE SUBJECT TO CHANGE WITHOUT NOTICE. CONTACT TMS LIGHTING FOR UPDATED SPECIFICATIONS.

**TMSLIGHTING**



# FLUX DIRECT™ PENDANT

**470FL**

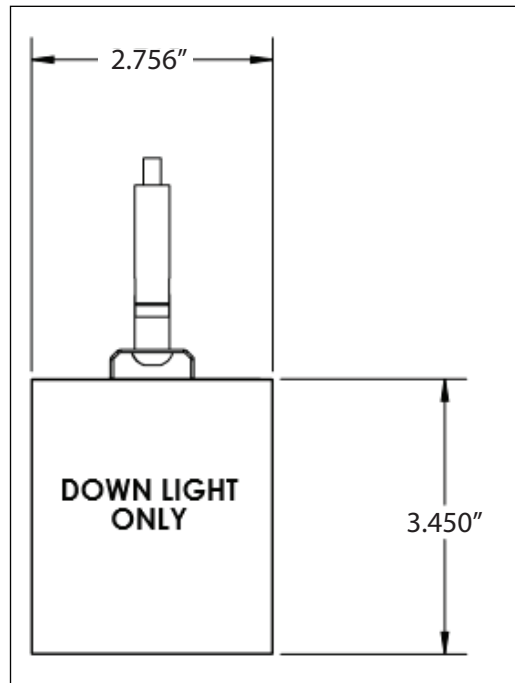

## SIZES (LENGTH)

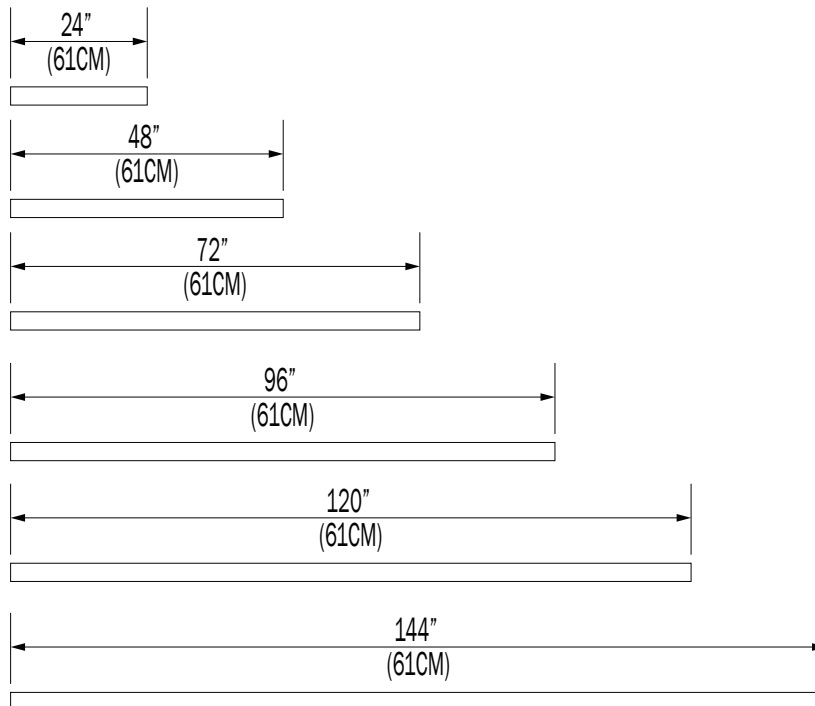

### CUSTOM

NOTE: THIS FIXTURE CAN BE CUSTOMIZE. DIMENSION, LAMP TYPES, ENCLOSURE, AND COLOR CAN BE MODIFIED TO SUIT YOUR LIGHTING AND ARCHITECTURAL REQUIREMENTS. CONTACT YOUR LOCAL REPRESENTATIVE FOR MORE DETAILS: <https://tmslighting.com/sales-agents.html>

# TMSLIGHTING

## STANDARD MOUNTING

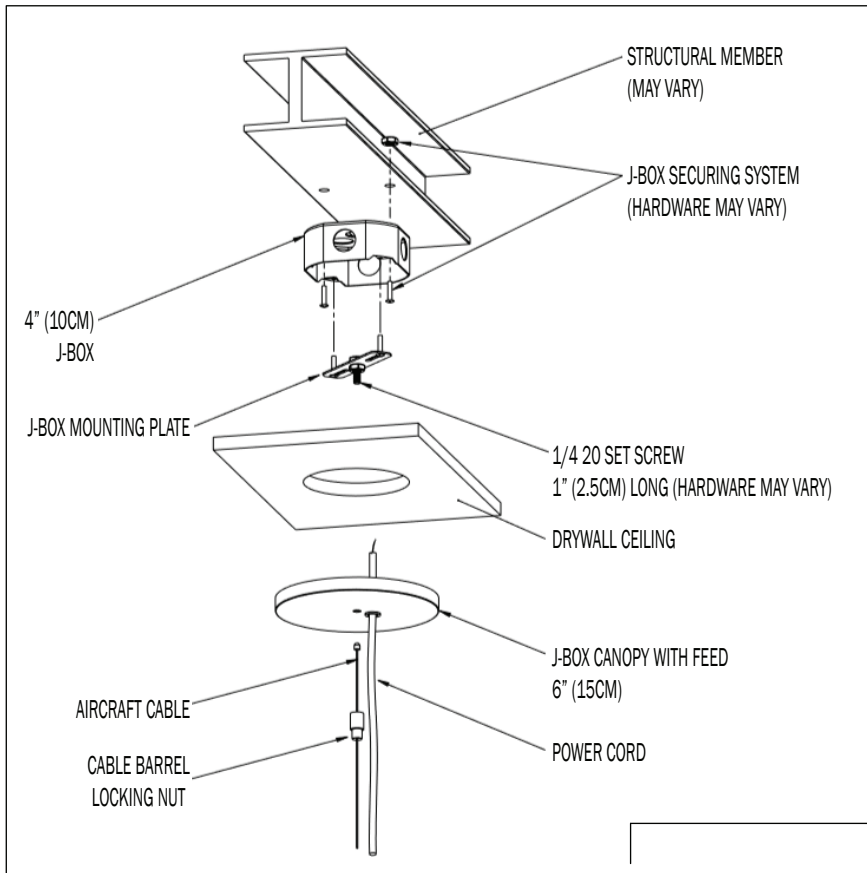

## T - BAR MOUNTING

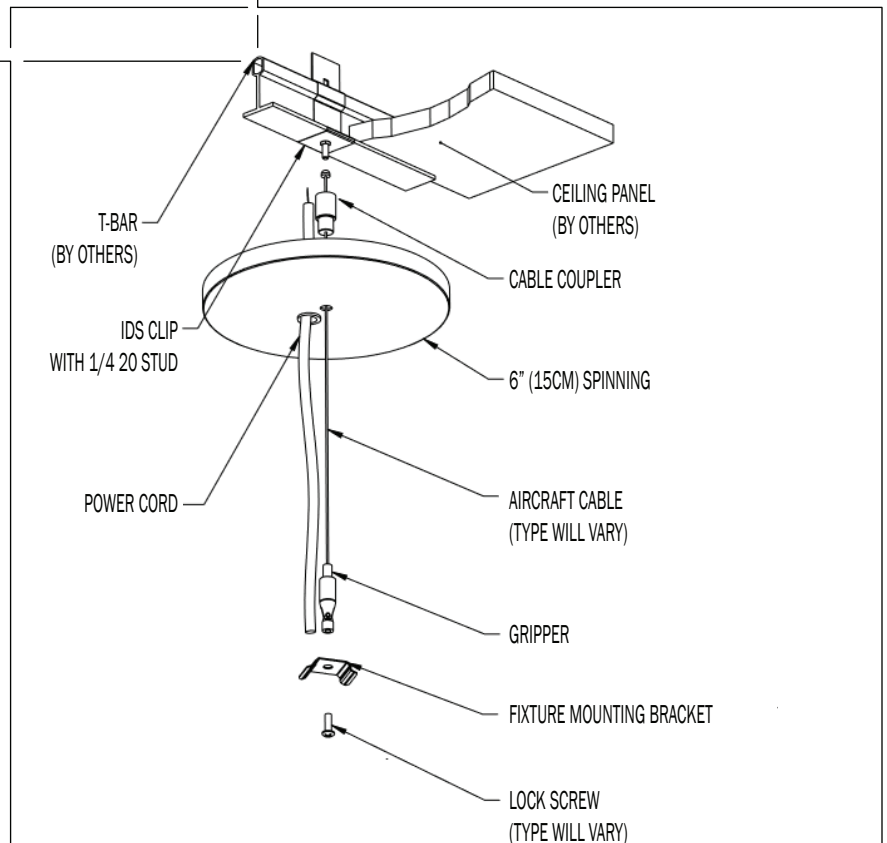

# FLUX DIRECT™ PENDANT

## DIRECT

PN	SIZE (LENGTH)	LUMENS	WATTAGE
470FL	24D	2799	27
	48D	5767	52
	72D	8653	78
	96D	11630	104
	120D	14258	130
	144D	17112	156

### IES INDOOR REPORT

PHOTOMETRIC FILENAME : 470FL D24 35K F05.IES

### POLAR GRAPH

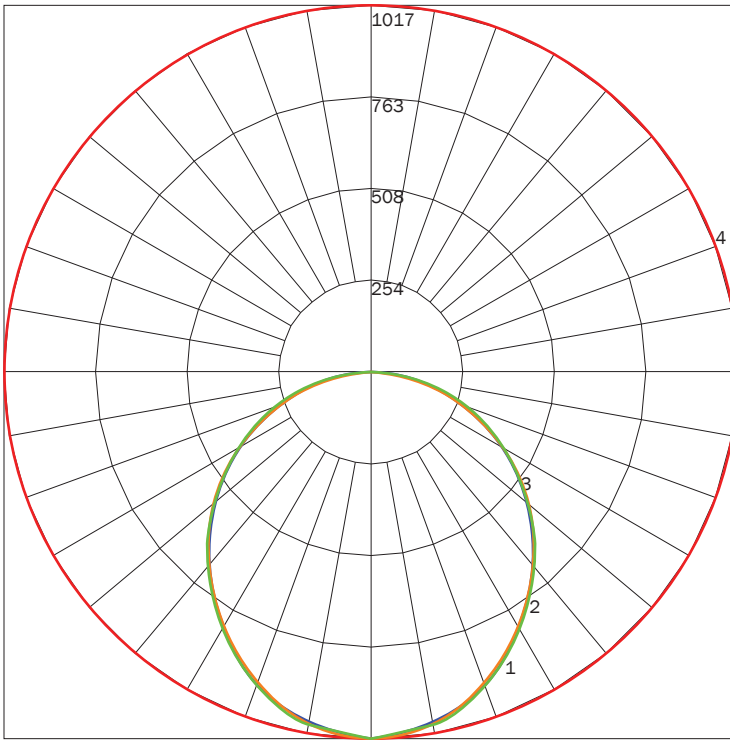

MAXIMUM CANDELA = 1016.78 LOCATED AT HORIZONTAL ANGLE = 0, VERTICAL ANGLE = 0  
 # 1 - VERTICAL PLANE THROUGH HORIZONTAL ANGLES (0 - 180) (THROUGH MAX. CD.)  
 # 2 - VERTICAL PLANE THROUGH HORIZONTAL ANGLES (45 - 225)  
 # 3 - VERTICAL PLANE THROUGH HORIZONTAL ANGLES (90 - 270)  
 # 4 - HORIZONTAL CONE THROUGH VERTICAL ANGLE (0) (THROUGH MAX. CD.)

**LUMINAIRE LUMENS**

2799

**TOTAL LUMINAIRE EFFICIENCY**

81%

**LUMINAIRE EFFICACY RATING**

105

**TOTAL LUMINAIRE WATTS**

27

### IES INDOOR REPORT

PHOTOMETRIC FILENAME : 470FL D144 35K F05.IES

### POLAR GRAPH

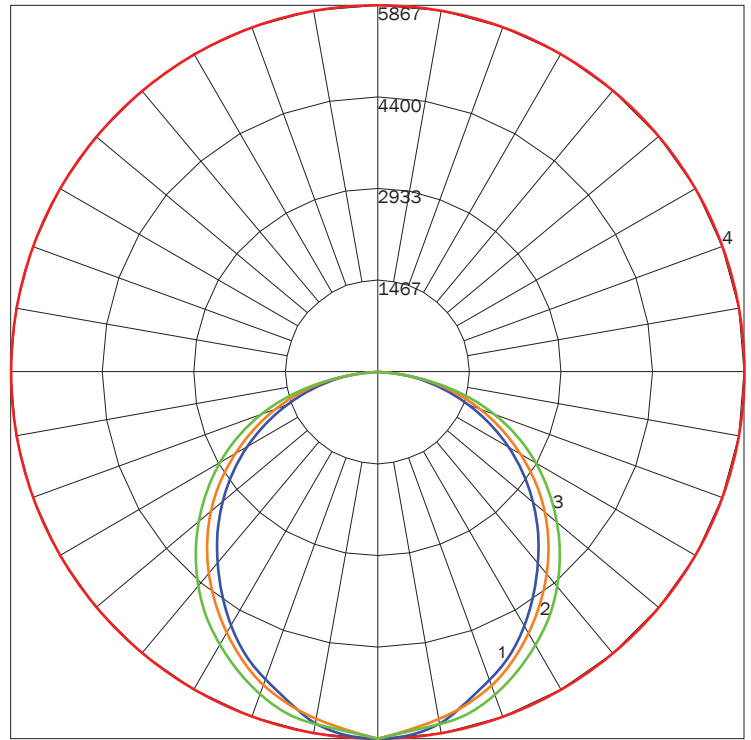

MAXIMUM CANDELA = 5866.58 LOCATED AT HORIZONTAL ANGLE = 0, VERTICAL ANGLE = 0  
 # 1 - VERTICAL PLANE THROUGH HORIZONTAL ANGLES (0 - 180) (THROUGH MAX. CD.)  
 # 2 - VERTICAL PLANE THROUGH HORIZONTAL ANGLES (45 - 225)  
 # 3 - VERTICAL PLANE THROUGH HORIZONTAL ANGLES (90 - 270)  
 # 4 - HORIZONTAL CONE THROUGH VERTICAL ANGLE (0) (THROUGH MAX. CD.)

**LUMINAIRE LUMENS**

17112

**TOTAL LUMINAIRE EFFICIENCY**

83%

**LUMINAIRE EFFICACY RATING**

110

**TOTAL LUMINAIRE WATTS**

156

## AVAILABLE FINISHES

---



**AN**  
ANODIZED  
(SILVER)



**F04**  
MATTE  
WHITE



**F05**  
GLOSS  
WHITE



**F15**  
MATTE  
BLACK



**F16**  
GLOSS  
BLACK



**F18**  
SATIN  
ALUMINUM



**RAL**  
CUSTOM  
COLOR  
(RAL #)

NOTE: DISPLAYED FINISHES DIFFER BETWEEN SCREENS AS WELL AS PRINTERS AND MAY NOT ACCURATELY DEPICT COLOR.