

FLUX DIRECT™ PENDANT

PROJECT: _____

TYPE: _____

QUANTITY: _____



PN: 470FL

| | |
|---------------------|---|
| APPLICATION | <ul style="list-style-type: none">• PENDANT MOUNT• INDOOR RATED |
| DIMENSION | <ul style="list-style-type: none">• 24", 48", 72", 96", 120", 144" (61CM, 122CM, 183CM, 244CM, 305CM, 366CM)• PROFILE: 2.756"W X 3.450"H (7CM X 8.8CM) |
| ILLUMINATION | <ul style="list-style-type: none">• DIRECT• LED 90CRI• 2,799 - 17,112 LUMENS |
| ELECTRICAL | <ul style="list-style-type: none">• 120, 277V AND UNI (120 - 277V)• 10kA SURGE SUPPRESSION STANDARD |
| DIFFUSERS | <ul style="list-style-type: none">• HIGH EFFICIENCY ACRYLIC |
| MOUNTING | <ul style="list-style-type: none">• 96" (244CM) BLACK OR WHITE DROP CORD W/ AIRCRAFT CABLES |
| CONSTRUCTION | <ul style="list-style-type: none">• ALUMINUM |
| FINISHES | <ul style="list-style-type: none">• AVAILABLE SPECIALTY, AND IN SEVERAL TMS POWDER COATED FINISHES• CUSTOM RAL FINISHES AVAILABLE |
| DIMMING | <ul style="list-style-type: none">• 0 - 10V STANDARD DIMMING (1%) |



TMSLIGHTING



FLUX DIRECT™ PENDANT

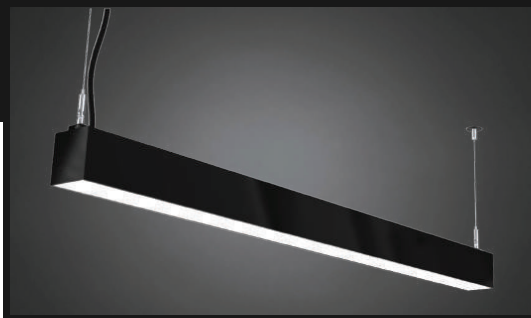

PROJECT: _____

TYPE: _____

QUANTITY: _____

470FL

1 2 3 4 5 6 7 8 9 10

| 1. | 24D | 48D | 72D | 96D | 120D | 144D |
|---------|------------------|-------------------|-------------------|-------------------|--------------------|--------------------|
| LENGTH | 24"(61CM) DIRECT | 48"(122CM) DIRECT | 72"(183CM) DIRECT | 96"(244CM) DIRECT | 120"(305CM) DIRECT | 144"(366CM) DIRECT |
| LED (W) | 27W | 52W | 78W | 104W | 130W | 156W |
| LENGTH | 2799 | 5767 | 8653 | 11630 | 14258 | 17112 |

| 2. | 30K | 35K | 40K |
|---------|-------|-------|-------|
| LED CCT | 3000K | 3500K | 4000K |

| 3. | S |
|----------|--------|
| CIRCUITS | SINGLE |

| 4. | SW | BL |
|----------|-------|------------|
| DIFFUSER | SATIN | BLACK LENS |

| 5. | ACC | ACT |
|----------|--------------|------------------------|
| MOUNTING | CABLE & CORD | CABLE & CORD FOR T-BAR |

| 6. | BC | WC |
|------|-----------------|-----------------|
| CORD | BLACK DROP CORD | WHITE DROP CORD |

| 7. | ADDITIONAL AND PREMIUM FINISHES AVAILABLE. SEE FINISHES CHART | | | F04 | F05 | F15 | F16 | F09 | F31 | F18 |
|--------|---|---------------|---------------|-----------------|---------------|--------------|-----------------|--------------|-----------------|-----------------|
| FINISH | | | | F06 | F07 | F08 | F10 | F11 | F13 | F14 |
| | CLAY BROWN | ZEUS BROWN | MIDNIGHT BLUE | FIRE RED | CITRUS ORANGE | FOREST GREEN | SUNSHINE YELLOW | ARCH. BRONZE | HARVEST GOLD | MELTED PLATINUM |
| | F25 | F26 | F28 | F32 | F33 | F38 | F39 | F40 | F41 | F45 |
| | MELTED GOLD | MELTED COPPER | DARK CAMPAGNE | BRONZE METALLIC | PYRITE BRONZE | MEADOW GREEN | AQUA BLUE | BUBBLE PINK | ELECTRIC PURPLE | COPPER METALLIC |
| | | | | | | | | | | |

| 8. | --- | EMR |
|------------------------|------|--------|
| EMERGENCY ¹ | NONE | REMOTE |

| 9. | --- | DOS | DS | OS |
|---------|------|--------------------|----------|-----------|
| SENSORS | NONE | DAYLIGHT/OCCUPANCY | DAYLIGHT | OCCUPANCY |

| 10. | DIML |
|---------|---|
| DIMMING | LED DIMMING (1%) (0 - 10V, CURRENT - SINKING) |

1. 6 - 10W AT 90 MINUTES. EMERGENCY IS ONLY AVAILABLE IN 120V - 277V SYSTEMS.

NOTE: SOME OPTIONS MAY NOT BE COMPATIBLE WITH OTHERS. ALL SPECIFICATIONS ARE SUBJECT TO CHANGE WITHOUT NOTICE. CONTACT TMS LIGHTING FOR UPDATED SPECIFICATIONS.

TMSLIGHTING



FLUX DIRECT™ PENDANT

470FL

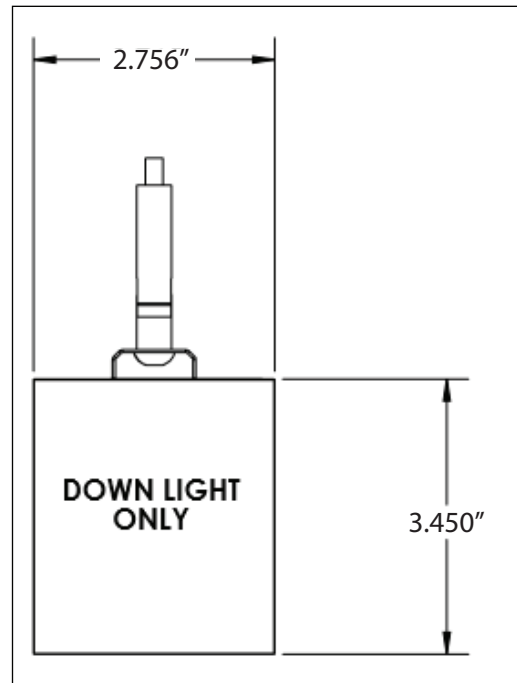

SIZES (LENGTH)

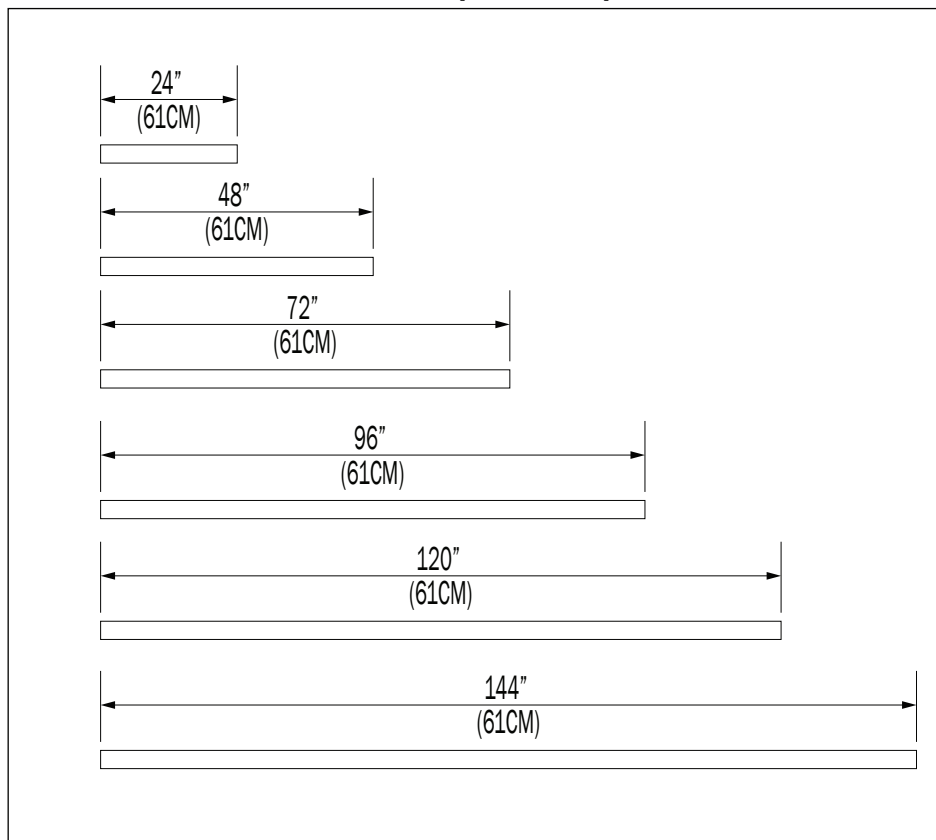

CUSTOM

NOTE: THIS FIXTURE CAN BE CUSTOMIZE. DIMENSION, LAMP TYPES, ENCLOSURE, AND COLOR CAN BE MODIFIED TO SUIT YOUR LIGHTING AND ARCHITECTURAL REQUIREMENTS. CONTACT YOUR LOCAL REPRESENTATIVE FOR MORE DETAILS: <https://tmslighting.com/sales-agents.html>

TMSLIGHTING

FLUX DIRECT™ PENDANT

STANDARD MOUNTING

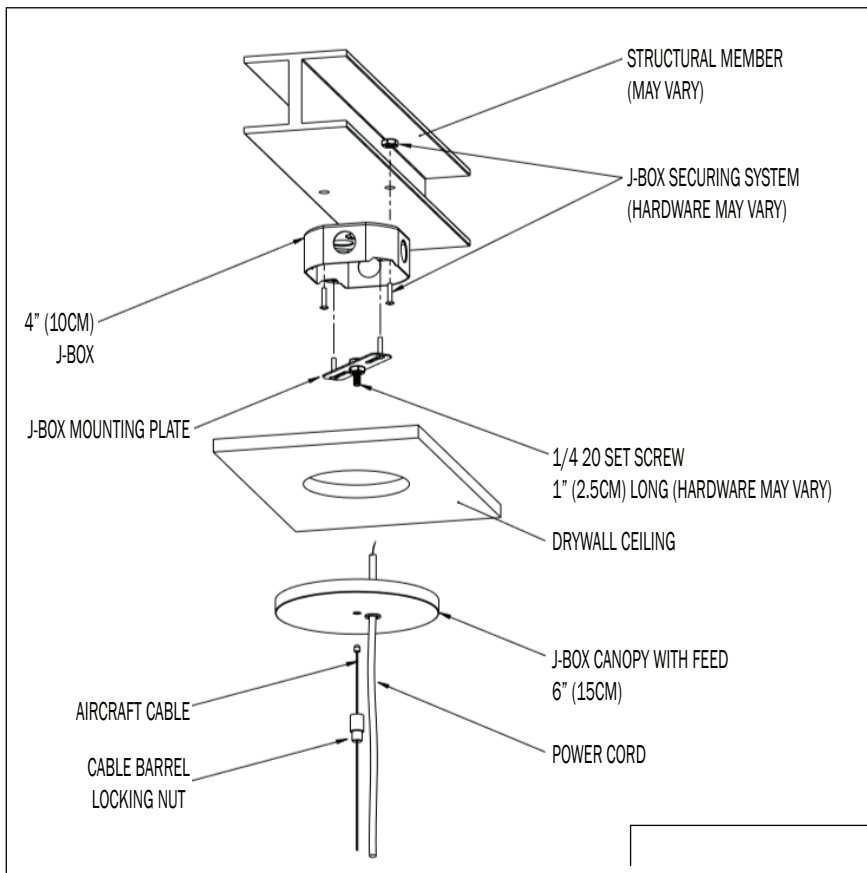

T - BAR MOUNTING

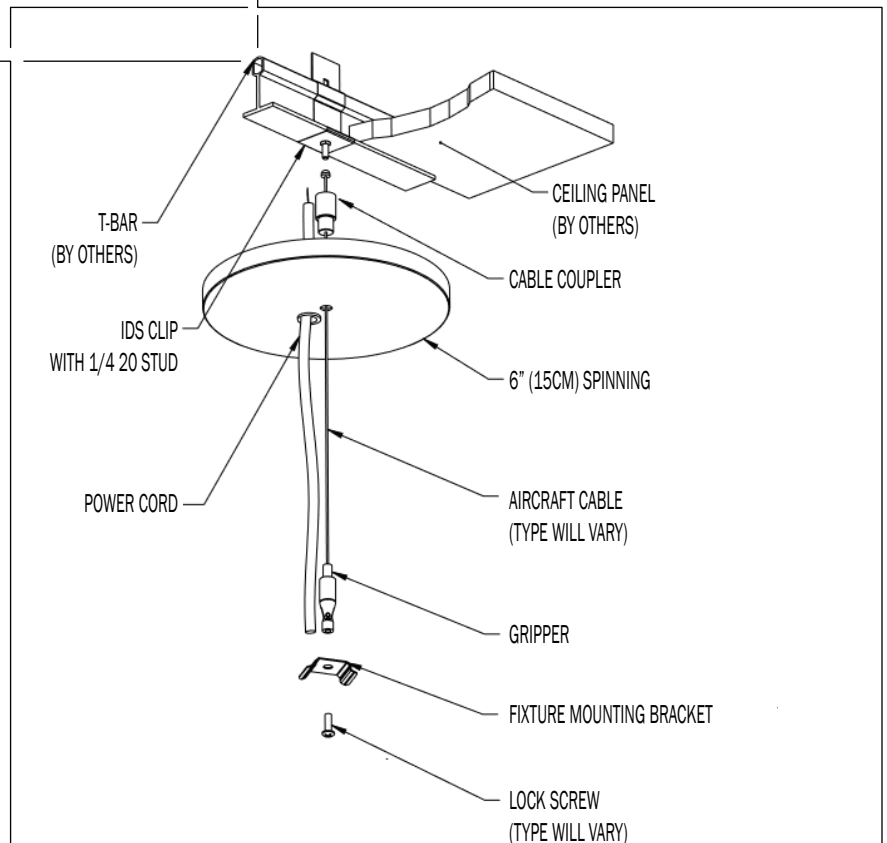

FLUX DIRECT™ PENDANT

DIRECT

| PN | SIZE (LENGTH) | LUMENS | WATTAGE |
|-------|---------------|--------|---------|
| 470FL | 24D | 2799 | 27 |
| | 48D | 5767 | 52 |
| | 72D | 8653 | 78 |
| | 96D | 11630 | 104 |
| | 120D | 14258 | 130 |
| | 144D | 17112 | 156 |

IES INDOOR REPORT

PHOTOMETRIC FILENAME : 470FL D24 35K F05.IES

POLAR GRAPH

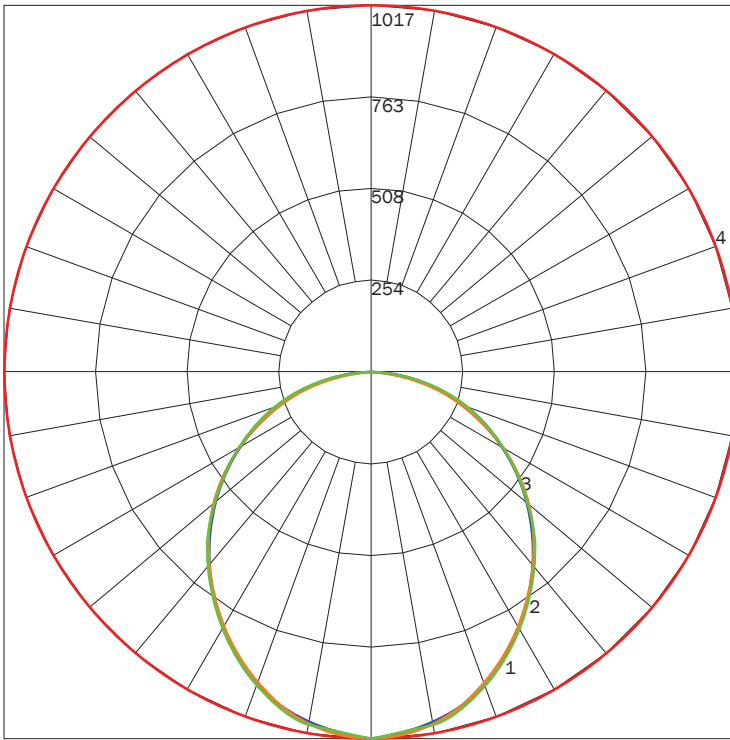

MAXIMUM CANDELA = 1016.78 LOCATED AT HORIZONTAL ANGLE = 0, VERTICAL ANGLE = 0
 # 1 - VERTICAL PLANE THROUGH HORIZONTAL ANGLES (0 - 180) (THROUGH MAX. CD.)
 # 2 - VERTICAL PLANE THROUGH HORIZONTAL ANGLES (45 - 225)
 # 3 - VERTICAL PLANE THROUGH HORIZONTAL ANGLES (90 - 270)
 # 4 - HORIZONTAL CONE THROUGH VERTICAL ANGLE (0) (THROUGH MAX. CD.)

LUMINAIRE LUMENS

2799

TOTAL LUMINAIRE EFFICIENCY

81%

LUMINAIRE EFFICACY RATING

105

TOTAL LUMINAIRE WATTS

27

IES INDOOR REPORT

PHOTOMETRIC FILENAME : 470FL D144 35K F05.IES

POLAR GRAPH

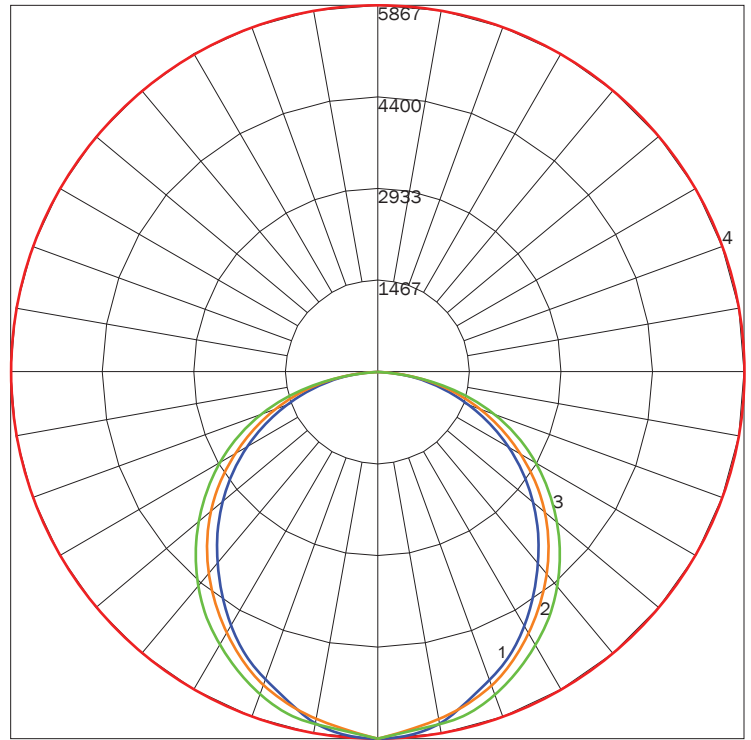

MAXIMUM CANDELA = 5866.58 LOCATED AT HORIZONTAL ANGLE = 0, VERTICAL ANGLE = 0
 # 1 - VERTICAL PLANE THROUGH HORIZONTAL ANGLES (0 - 180) (THROUGH MAX. CD.)
 # 2 - VERTICAL PLANE THROUGH HORIZONTAL ANGLES (45 - 225)
 # 3 - VERTICAL PLANE THROUGH HORIZONTAL ANGLES (90 - 270)
 # 4 - HORIZONTAL CONE THROUGH VERTICAL ANGLE (0) (THROUGH MAX. CD.)

LUMINAIRE LUMENS

17112

TOTAL LUMINAIRE EFFICIENCY

83%

LUMINAIRE EFFICACY RATING

110

TOTAL LUMINAIRE WATTS

156

FLUX DIRECT™ PENDANT

FINISHES



PREMIUM FINISHES



PREMIUM MATERIALS



NOTE: DISPLAYED FINISHES DIFFER BETWEEN SCREENS AS WELL AS PRINTERS AND MAY NOT ACCURATELY DEPICT COLOR.

TMSLIGHTING